

ZC Series

NOTE: Read through all instructions prior to installation. All material must be inspected for damage. Any damage must be reported to PROSPEC SPECIALTIES INC., as soon as possible. All work must be completed as per Architect's approval of material and shop drawings and installation must commence in accordance with these installation instructions.

Typical Installation Details:

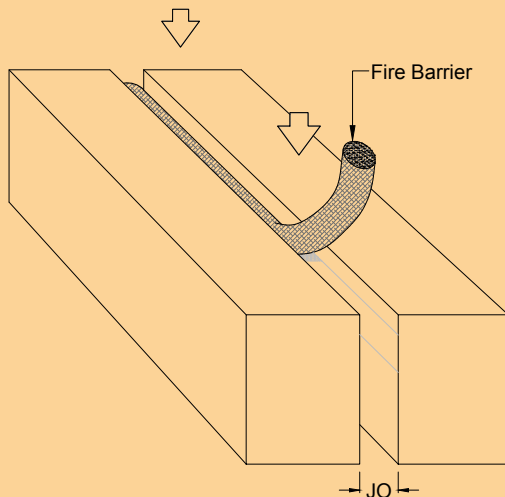

Floor to Floor Application:

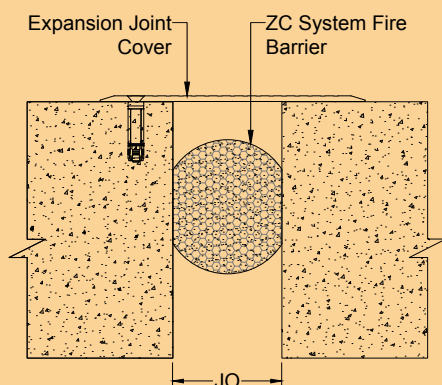

Wall to Wall Application:

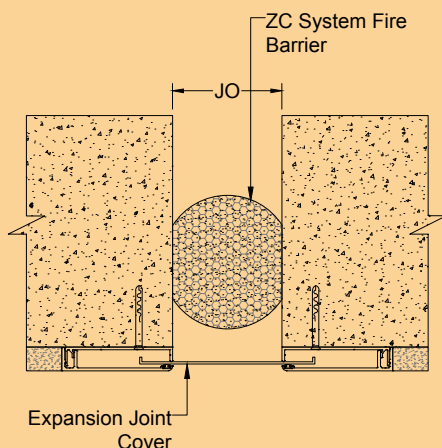

Preparation:

Verify that the structural gap is in conformance with submittal data before beginning installation. Substrate should be clean, clear, dry and free from grit. Remove dust using with air compressor.

Safety Precaution:

Wear gloves, dust mask, eye protection & protective overalls required during installation. Review all MSDS before commencing the installation.

Material Coverage:

Structural Gap Width	Mineral Wool Diameter
1" (25mm)	1-3/8" (35mm)
2" (51mm)	2-3/8" (60mm)
3" (76mm)	3-1/2" (90mm)
4" (102mm)	4-3/4" (120mm)
5" (127mm)	5-7/8" (150mm)

Installation Procedure:

The rope type fire barrier's it is simply installed by compressing and pushing it into the expansion joint at the desired level by hand or using an appropriate sized of wood if needed (*depth varies depends on what types of joint system to be cover over the fire barrier*).

Protection and Cleaning:

- Protect the installed fire barrier from damage by work of others.
- At completion of the installation, clean the exposed surfaces of the fire barrier's.

Install **Prospec Specialties** expansion joint cover over the fire barrier as per installation instructions.



PROSPEC SPECIALTIES INC. 3601 HIGHWAY 7,
SUITE 400, MARKHAM ON L3R 0M3 CANADA